

SOLAR MODULE
MONOCRYSTALLINE • 60 CELLS

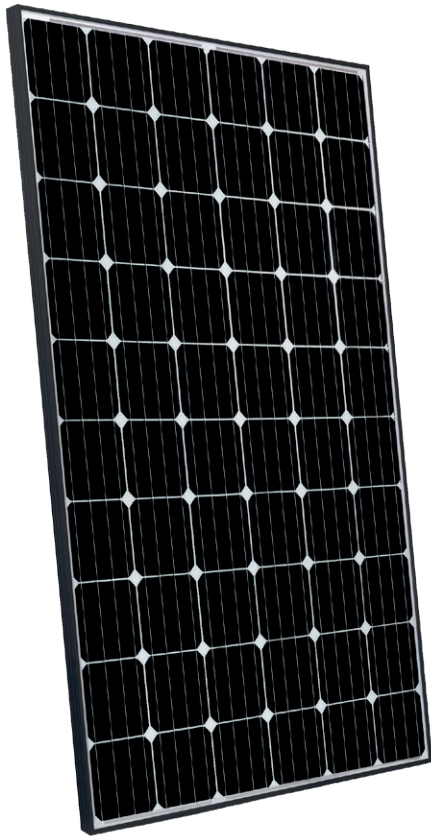

POSITIVE POWER
OUTPUT TOLERANCE



30 YEAR LINEAR POWER WARRANTY
20 YEAR PRODUCT WARRANTY



HAILSTORM RESISTANCE



STRONG YET ULTRA-LIGHT
ALUMINUM FRAME



ANTI-REFLECTIVE GLASS



MODULE FIRE PERFORMANCE: 1



Mono 60 cells • OS HIGH EFFICIENCY LINE
OS280M • OS290M • OS300M

PEIMAR monocrystalline solar panels, produced using a combination of innovative production processes and advanced engineering techniques, provide customers with maximum output and super high performance (over 20% efficiency). This allows fewer panels to be used to generate more energy, ideal if space is restricted or environmental conditions are challenging. We only work with certified suppliers and use the best materials to ensure our panels are extremely robust and resistant to atmospheric agents and accidental shocks. Modern design, using matching black cells and frames and a very long lifespan ensure this monocrystalline are a great option.

Cells

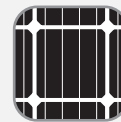

Type_ **MONO 3BB - 4BB**
Qty_ **60 pcs**
Dimensions_ **156x156 mm**
6x6 inch

Frame



BLACK

Backsheet



WHITE

ELECTRICAL Characteristics (STC)*

	OS280M	OS290M	OS300M
Nominal Output (Pmax)	280 W	290 W	300 W
Flash Test Power Tolerance	0/+5 W	0/+5 W	0/+5 W
Voltage at Pmax (Vmp)	31.2 V	31.6 V	32.0 V
Current at Pmax (Imp)	9.07 A	9.18 A	9.40 A
Open Circuit Voltage (Voc)	39.5 V	39.6 V	39.8 V
Short Circuit Current (Isc)	9.71 A	9.84 A	9.98 A
Maximum System Voltage	1000 V	1000 V	1000 V
Maximum Series Fuse Rating	15 A	15 A	15 A
Cell Efficiency	20.21 %	20.93 %	21.65 %
Module Efficiency	17.21 %	17.83 %	18.44 %

*STC (Standard Test Condition): Irradiance 1000W/m², Module Temperature 25°C, Air Mass 1.5

MECHANICAL Characteristics

Solar Cells	60 (6x10) monocrystalline
Solar Cells Size	156x156 mm / 6x6"
Front Cover	3.2 mm / 0.12" thick, low iron tempered glass
Back Cover	TPT (Tedlar-PET-Tedlar)
Encapsulant	EVA (Ethylene vinyl acetate)
Frame	Anodized aluminium alloy, double wall
Frame finishing	Black
Backsheet finishing	White
Diodes	3 Bypass diodes serviceable
Junction Box	IP65 rated
Connector	MC4 or compatible connector
Cables Length	900 mm / 35.4"
Cables Section	4.0 mm ² / 0,006 in ²
Dimensions	1640x992x40 mm / 64,5x39x1,57"
Weight	18 Kg / 39.7 lb
Max. Load	Certified to 5400 Pa

TEMPERATURE Characteristics

NOCT**	45±2 °C
Temperature Coefficient of Pmax	-0.43 %/°C
Temperature Coefficient of Voc	-0.32 %/°C
Temperature Coefficient of Isc	0.047 %/°C
Operating Temperature	-40 °C ~ +85°C

**NOCT: Nominal Operation Cell Temperature Sun 800W/m²; Air 20°C; Wind speed 1m/s

PACKAGING ***

Pallet dimensions	1700x1100x1200 mm / 67x43x47"
Pieces per pallet	27
Weight	516 Kg / 1138 lb

*** Pallets can be stacked up to two

CERTIFICATIONS

Fire Resistance Rating	1 (UNI 9177)
------------------------	--------------

DIMENSIONS

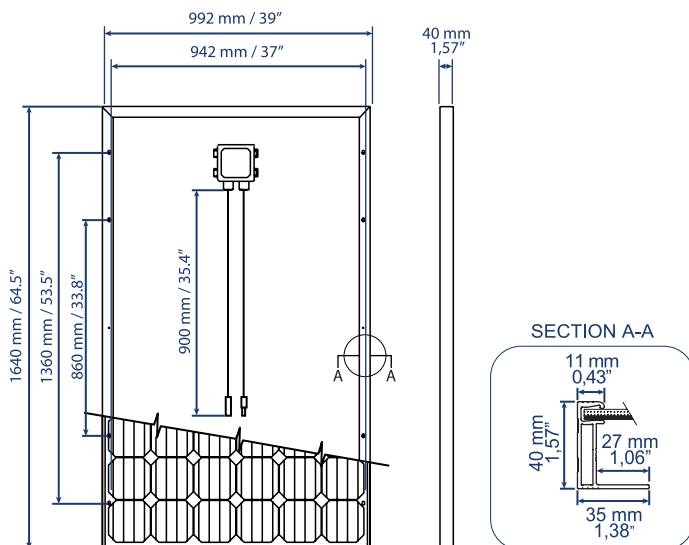

CURRENT/VOLTAGE Characteristics

• Values apply to panel OS300M

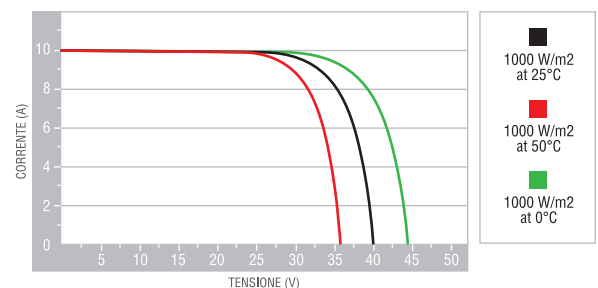
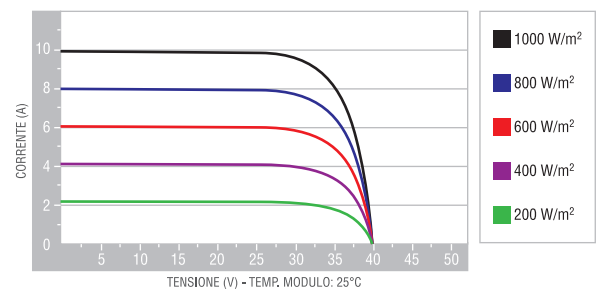

It is important to point out, that all technical specifications, information and figures contained in this datasheet are estimated values. Peimar reserves the right to change the technical specifications, information and figures contained in this document at any time and without notice.

ITALIA • Via Creta 72, 25124 Brescia • Tel. +39030223292
 USA • 309 Fellowship Road, Mt Laurel, NJ 08054 • Phone: +1 856-642-4035
 CHINA • Zhongminngda Plaza, 361000 Xiamen • Phone: +86-136-9696-2396

BRAZIL • Rua Cidade do Sol 5940, 59066-180 Pitimbu-Natal, RN • Phone: +55 84-3218-0348
 AUSTRALIA • Hawthorn, 737 Burwood Rd, Melbourne VIC • Phone: 3123+613 8862 5487

/// PEIMAR

info@peimar.com
 www.peimar.com